

# 过渡接头 ADAPTER

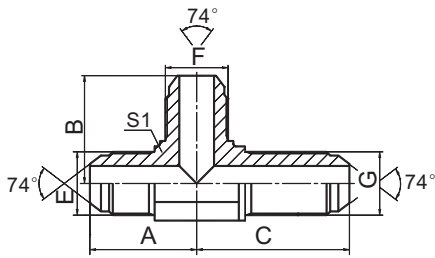

**AJJ6J**

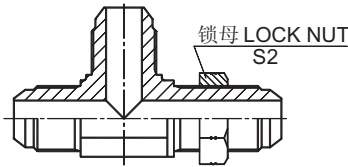

**AJJ6J-LN**

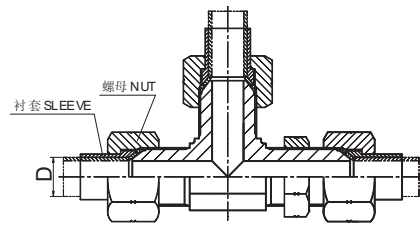

JIC 外螺纹 74° 外锥  
JIC MALE 74° CONE

代号 PART NO.	螺纹 THREAD			尺寸 DIMENSIONS					
	E	F	G	A	B	C	S1	S2	
AJJ6J-04	7/16"X20	7/16"X20	7/16"X20	24.5	24.5	40.4	11	17	
AJJ6J-05	1/2"X20	1/2"X20	1/2"X20	26.6	26.6	43.7	14	19	
AJJ6J-06	9/16"X18	9/16"X18	9/16"X18	26.9	26.9	46	14	22	
AJJ6J-08	3/4"X16	3/4"X16	3/4"X16	32	32	53.5	19	24	
AJJ6J-10	7/8"X14	7/8"X14	7/8"X14	37.8	37.8	60.7	22	30	
AJJ6J-12	1.1/16"X12	1.1/16"X12	1.1/16"X12	44.2	44.2	67.8	27	36	
AJJ6J-16	1.5/16"X12	1.5/16"X12	1.5/16"X12	49	49	71	33	41	
AJJ6J-20	1.5/8"X12	1.5/8"X12	1.5/8"X12	55.3	55.3	79.2	41	50	
AJJ6J-24	1.7/8"X12	1.7/8"X12	1.7/8"X12	63.5	63.5	86.9	48	55	

注：如需带锁母订货，则请在代号后加“LN”，如 AJJ6J-12LN。螺母及衬套需另行订货，管子直径 D 为公制时，配用螺母及衬套分别选用 NB200、NB500。管子直径为英制时，配用螺母及衬套分别选用 NB200、NB300。

Note: In case if you are interested to order the adapter with lock nut, please insert suffix "LN" after our part no, for example AJJ6J-12LN. Nut and sleeve should be ordered separately, The nut NB200 and sleeve NB500 is suitable for metric tube, the nut NB200 and sleeve NB300 is suitable for inch tube.