

过渡接头 ADAPTER

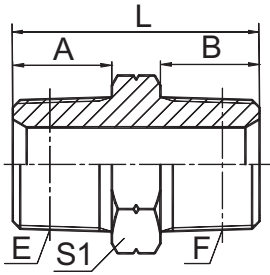

1N

美制布锥管外螺纹
NPT MALE

| 代号 PART NO. | 螺纹 THREAD | | 尺寸 DIMENSIONS | | | | | |
|----------------|--------------|--------------|---------------|------|------|----|--|--|
| | E | F | A | B | L | S1 | | |
| 1N-02 | Z1/8"X27 | Z1/8"X27 | 10.5 | 10.5 | 27 | 12 | | |
| 1N-02-04 | Z1/8"X27 | Z1/4"X18 | 10.5 | 15 | 31 | 17 | | |
| 1N-02-06 | Z1/8"X27 | Z3/8"X18 | 10.5 | 16 | 32 | 19 | | |
| 1N-04 | Z1/4"X18 | Z1/4"X18 | 15 | 15 | 35 | 17 | | |
| 1N-04-06 | Z1/4"X18 | Z3/8"X18 | 15 | 16 | 37 | 19 | | |
| 1N-04-08 | Z1/4"X18 | Z1/2"X14 | 15 | 19.5 | 41.5 | 22 | | |
| 1N-06 | Z3/8"X18 | Z3/8"X18 | 16 | 16 | 38 | 19 | | |
| 1N-06-08 | Z3/8"X18 | Z1/2"X14 | 16 | 19.5 | 43.5 | 22 | | |
| 1N-06-12 | Z3/8"X18 | Z3/4"X14 | 16 | 19.5 | 45.5 | 27 | | |
| 1N-08 | Z1/2"X14 | Z1/2"X14 | 19.5 | 19.5 | 47 | 22 | | |
| 1N-08-12 | Z1/2"X14 | Z3/4"X14 | 19.5 | 19.5 | 49 | 27 | | |
| 1N-08-16 | Z1/2"X14 | Z1"X11.5 | 19.5 | 25.5 | 56 | 36 | | |
| 1N-12 | Z3/4"X14 | Z3/4"X14 | 19.5 | 19.5 | 49 | 27 | | |
| 1N-12-16 | Z3/4"X14 | Z1"X11.5 | 19.5 | 25.5 | 55 | 36 | | |
| 1N-12-20 | Z3/4"X14 | Z1.1/4"X11.5 | 19.5 | 26.5 | 59 | 46 | | |
| 1N-16 | Z1"X11.5 | Z1"X11.5 | 25.5 | 25.5 | 61 | 36 | | |
| 1N-16-20 | Z1"X11.5 | Z1.1/4"X11.5 | 25.5 | 26.5 | 64 | 46 | | |
| 1N-16-24 | Z1"X11.5 | Z1.1/2"X11.5 | 25.5 | 27.5 | 68 | 50 | | |
| 1N-20 | Z1.1/4"X11.5 | Z1.1/4"X11.5 | 26.5 | 26.5 | 65 | 46 | | |
| 1N-20-24 | Z1.1/4"X11.5 | Z1.1/2"X11.5 | 26.5 | 27.5 | 69 | 50 | | |
| 1N-24 | Z1.1/2"X11.5 | Z1.1/2"X11.5 | 27.5 | 27.5 | 69 | 50 | | |
| 1N-24-32 | Z1.1/2"X11.5 | Z2"X11.5 | 27.5 | 27.5 | 72 | 65 | | |
| 1N-32 | Z2"X11.5 | Z2"X11.5 | 27.5 | 27.5 | 71 | 65 | | |

| | |
|--------------|------|
| Z1/8"X27 | 10.5 |
| Z1/4"X18 | 15 |
| Z3/8"X18 | 16 |
| Z1/2"X14 | 19.5 |
| Z3/4"X14 | 19.5 |
| Z1"X11.5 | 25.5 |
| Z1.1/4"X11.5 | 26.5 |
| Z1.1/2"X11.5 | 27.5 |
| Z2"X11.5 | 27.5 |