

过渡接头 ADAPTER

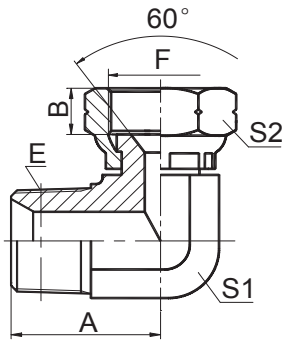

2TS9-SP

90° 英锥管外螺纹 / 日本英管内螺纹 60°
 90° BSPT MALE / JIS BSP FEMALE 60°

代号 PART NO.	螺纹 THREAD		尺寸 DIMENSIONS						
	E	F			A	B	S1	S2	
2TS9-04SP	R1/4"X19	G1/4"X19			25.5	8	14	19	
2TS9-06SP	R3/8"X19	G3/8"X19			28.5	9	16	22	
2TS9-08SP	R1/2"X14	G1/2"X14			36	12	22	27	
2TS9-12SP	R3/4"X14	G3/4"X14			43.5	13.5	27	32	
2TS9-16SP	R1"X11	G1"X11			50	16	33	41	
2TS9-20SP	R1.1/4"X11	G1.1/4"X11			58	18.5	41	50	
2TS9-24SP	R1.1/2"X11	G1.1/2"X11			62.5	19	48	55	